

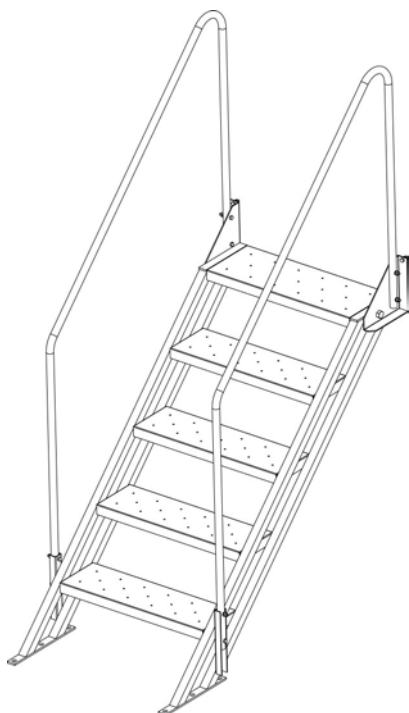

## ASSEMBLY INSTRUCTIONS FOR FDS 4 & FDS 8



### **FDS 4: 4 ft. Stair Assembly**

Refer to pages 1-4 for assembly instructions

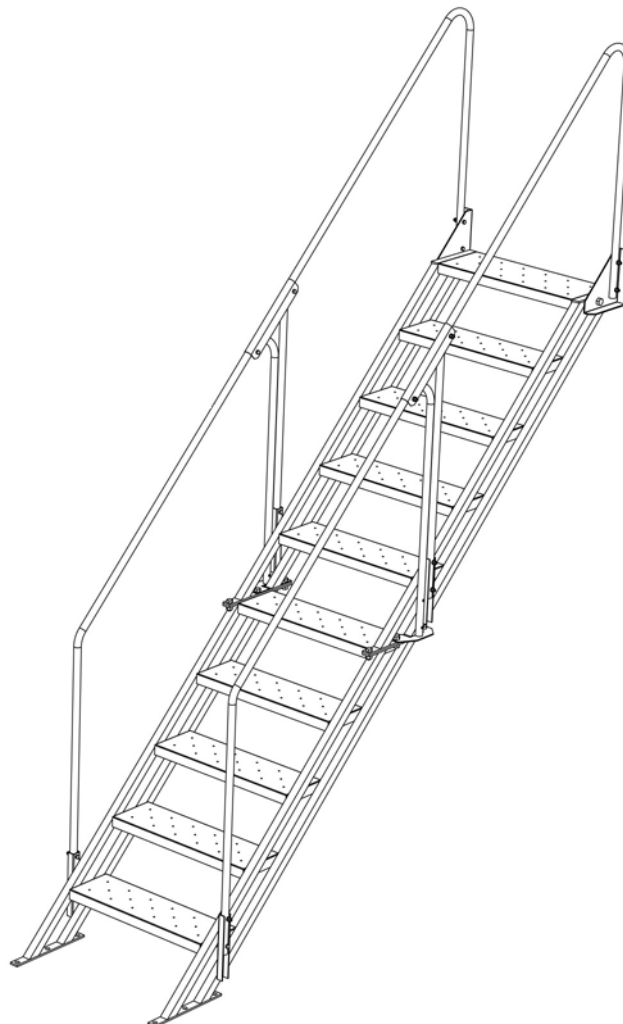

### **FDS 8: 8 ft. Stair Assembly**

Refer to pages 5-10 for assembly instructions. Note: Remove hardware bags from both boxes before beginning.

## ASSEMBLY INSTRUCTIONS FOR FDS 4

### HARDWARE LIST FOR FDS 4 (4 ft. Stair Assembly)

| Quantity | Part Name        | Description                        |
|----------|------------------|------------------------------------|
| 2        | Bolt A           | 5/8" x 2.25" L Bolt                |
| 2        | Lock Nut A       | 5/8" Nylon Insert Lock Nut         |
| 2        | Lock Washer A    | 5/8" Split Lock Washer             |
| 2        | Spacer Bushing A | .88" O.D. x 1.25" L Spacer Bushing |
| 2        | Bolt B           | 5/16" x 1.00" L Bolt               |
| 10       | Lock Nut B       | 5/16" Keps Lock Nut                |
| 8        | Bolt C           | 5/16" x 1.75" L Bolt               |

### IMPORTANT NOTICE

User is responsible for proper assembly, setup & anchoring

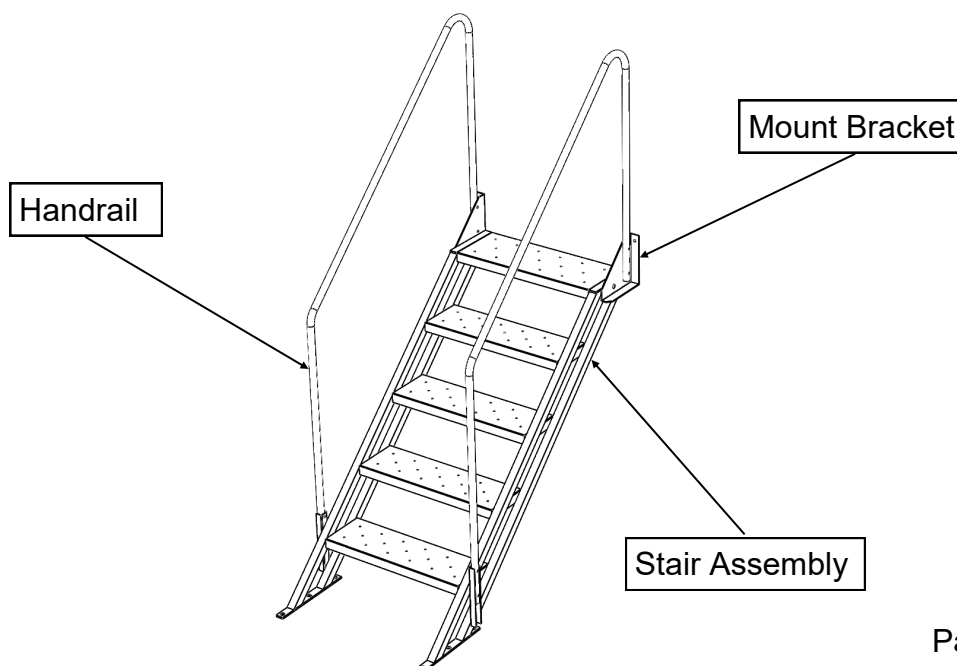

**Step 1:** Attach both **Mount Brackets** to the top of the **Stair Assembly** using Bolt A, Lock Washer A, Lock Nut A & Spacer Bushing A. **Do not tighten hardware all the way until after the handrails are installed in Step 3.** (Figure 1 )

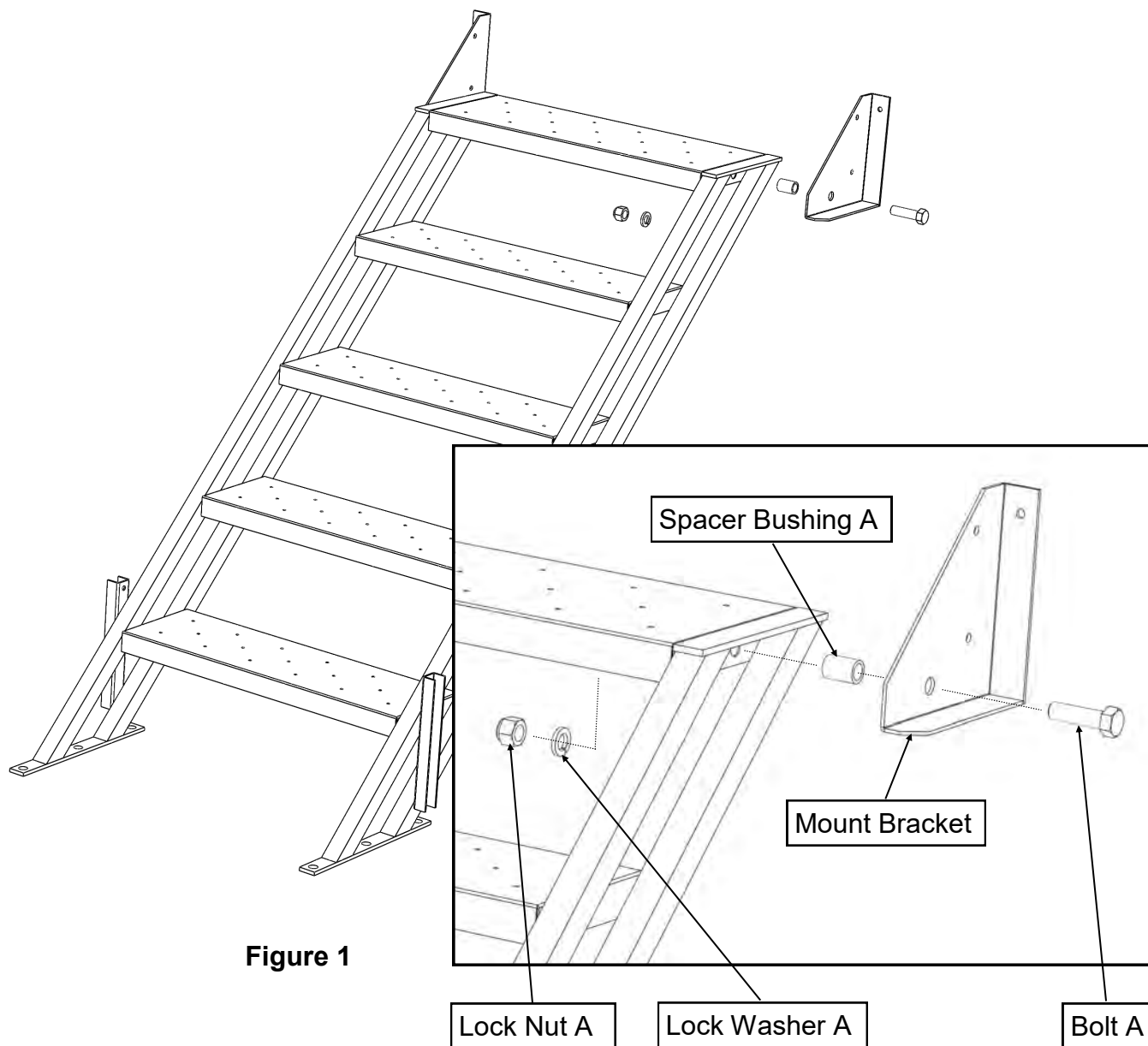

**Step 2:** Attach both sides of the **Stair Assembly with Mount Brackets** to the blind's base using Bolt B & Lock Nut B. **Tighten all hardware securely.** (Figure 2 )

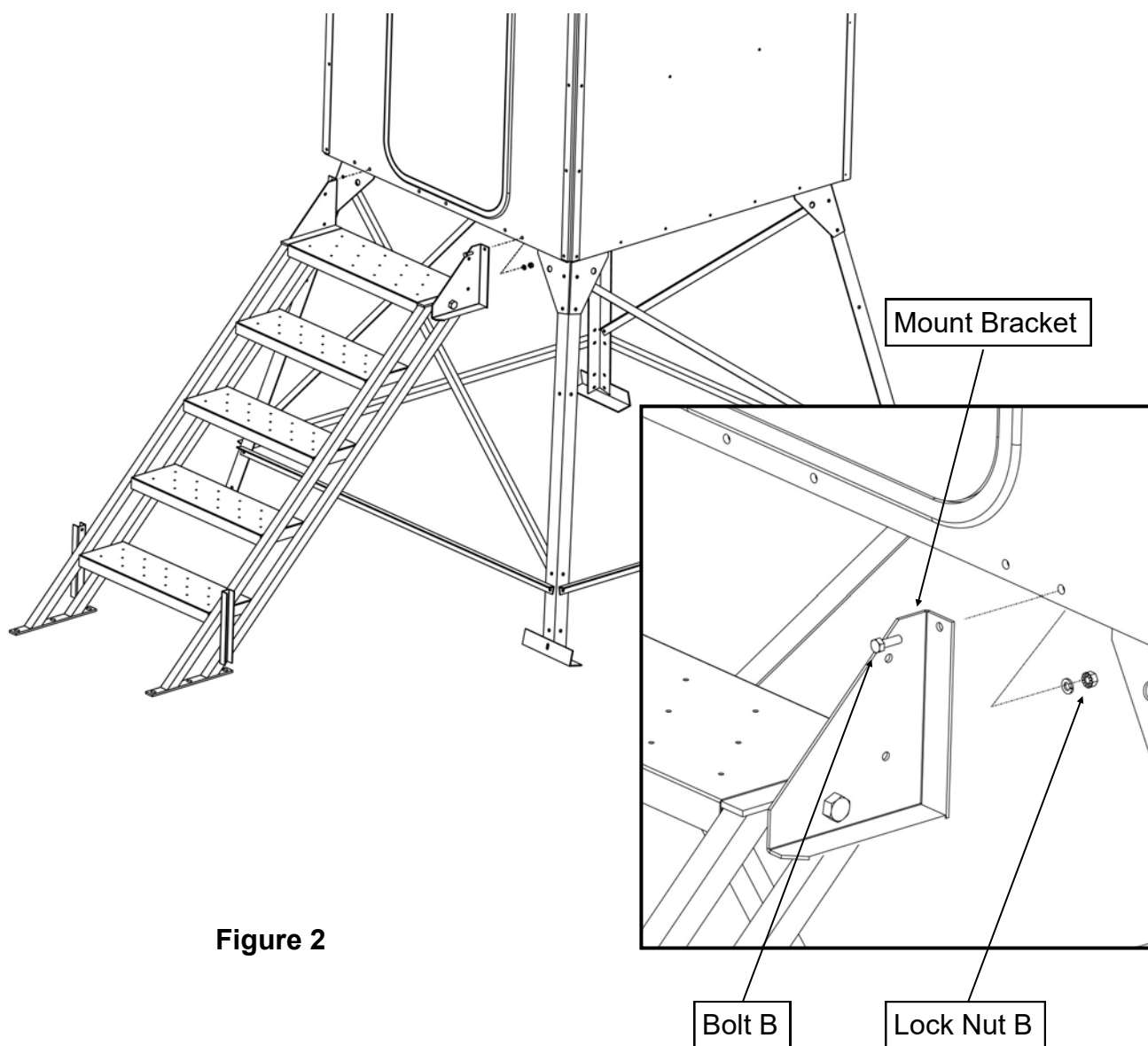

**Figure 2**

**Step 3:** Attach both **Handrails** to the upper & lower mount brackets in the stair assembly using Bolt C & Lock Nut B. Install (4) bolts per handrail. Note that the lowest bolt on each side gets installed from the outside in. **Tighten all hardware securely. IMPORTANT: Go back & tighten Bolt A, Lock Washer A & Lock Nut A from Step 1. (Figure 3 )**

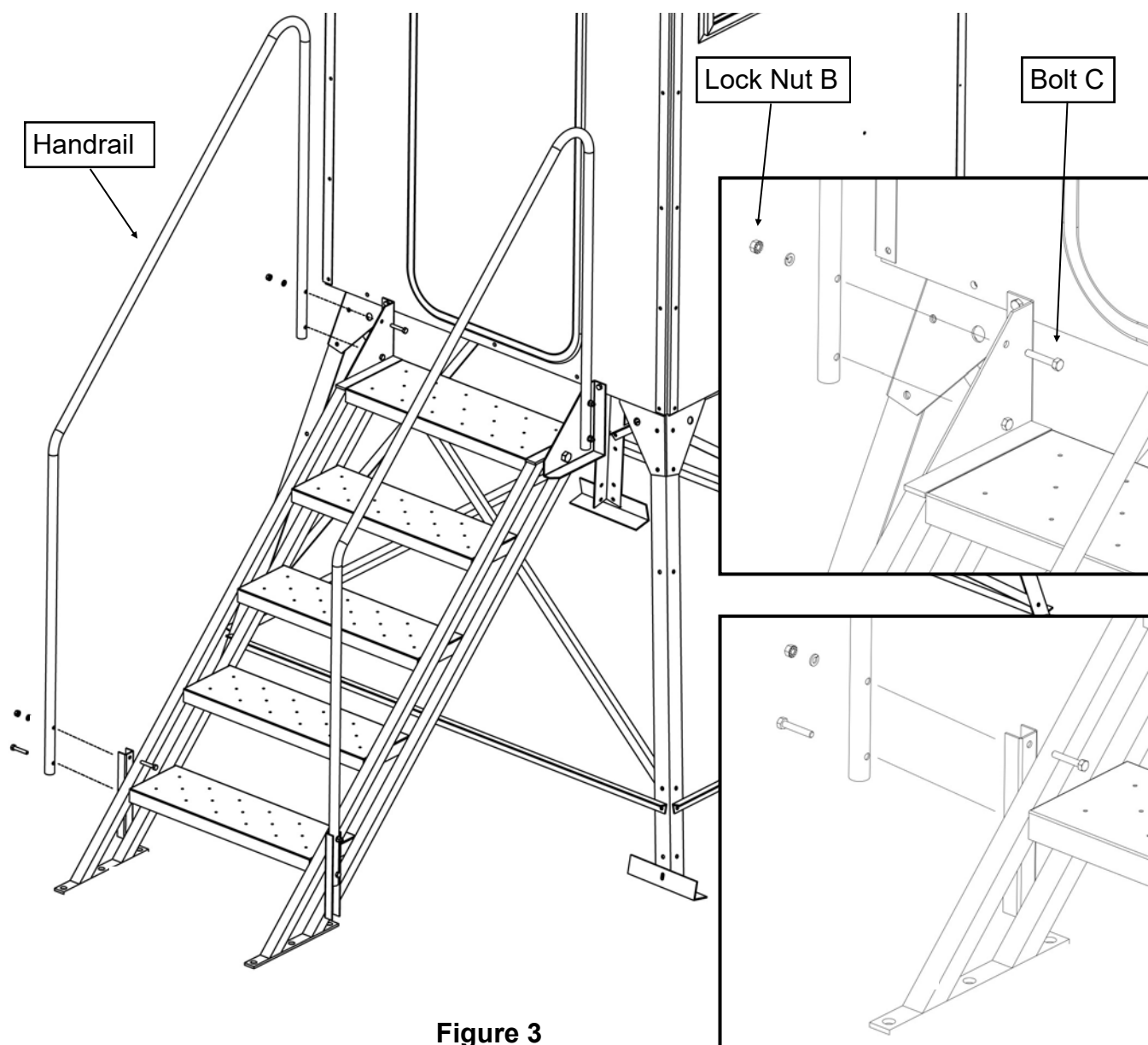

**Figure 3**

### ASSEMBLY INSTRUCTIONS FOR FDS 8

#### HARDWARE LIST FOR FDS 8 (4 ft. Stair Assembly)

| Quantity | Part Name        | Description                        |
|----------|------------------|------------------------------------|
| 2        | Bolt A           | 5/8" x 2.25" L Bolt                |
| 2        | Lock Nut A       | 5/8" Nylon Insert Lock Nut         |
| 2        | Lock Washer A    | 5/8" Split Lock Washer             |
| 2        | Spacer Bushing A | .88" O.D. x 1.25" L Spacer Bushing |
| 6        | Bolt D           | 1/2" x 1.25" L Bolt                |
| 6        | Lock Washer C    | 1/2" Split Lock Washer             |
| 6        | Nut C            | 1/2" Nut                           |
| 16       | Bolt C           | 5/16" x 1.75" L Bolt               |
| 18       | Lock Nut B       | 5/16" Keps nut                     |
| 2        | Bolt B           | 5/16" x 1.00" L                    |

**Note: Hardware bags are located in both boxes.  
Remove & review all hardware before beginning.**

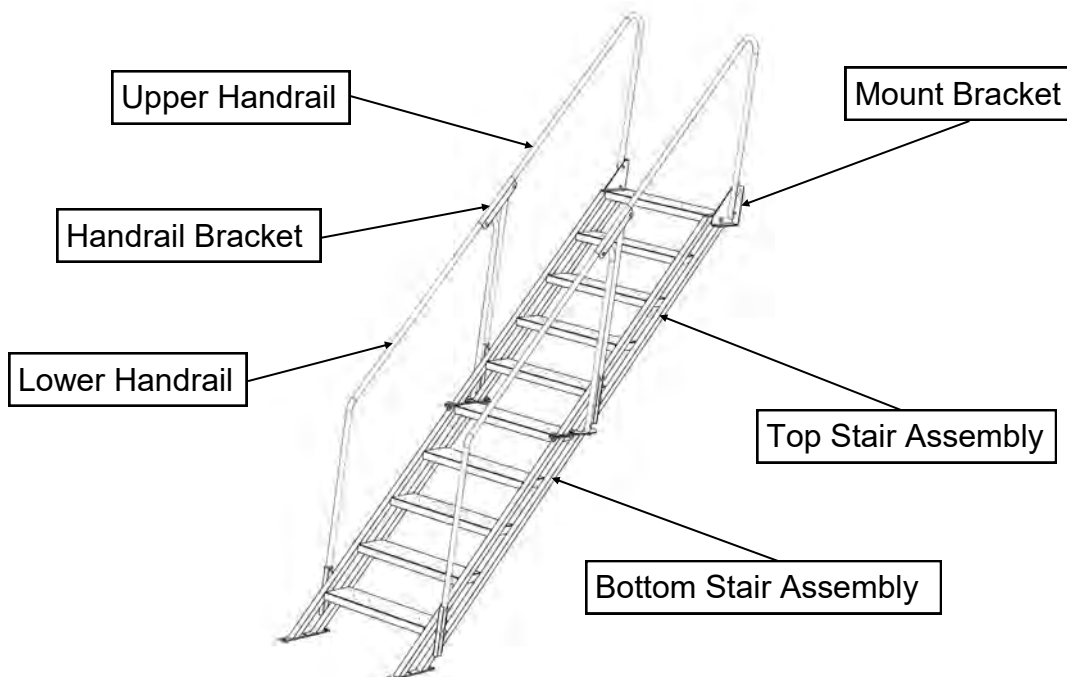

**Step 1:** Attach both **Mount Brackets** to the top of the **Top Stair Assembly** using Bolt A, Lock Nut A, Lock Washer A & Spacer Bushing A. **Do not tighten hardware all the way until after the upper handrails are installed in Step 5.** (Figure 1 )

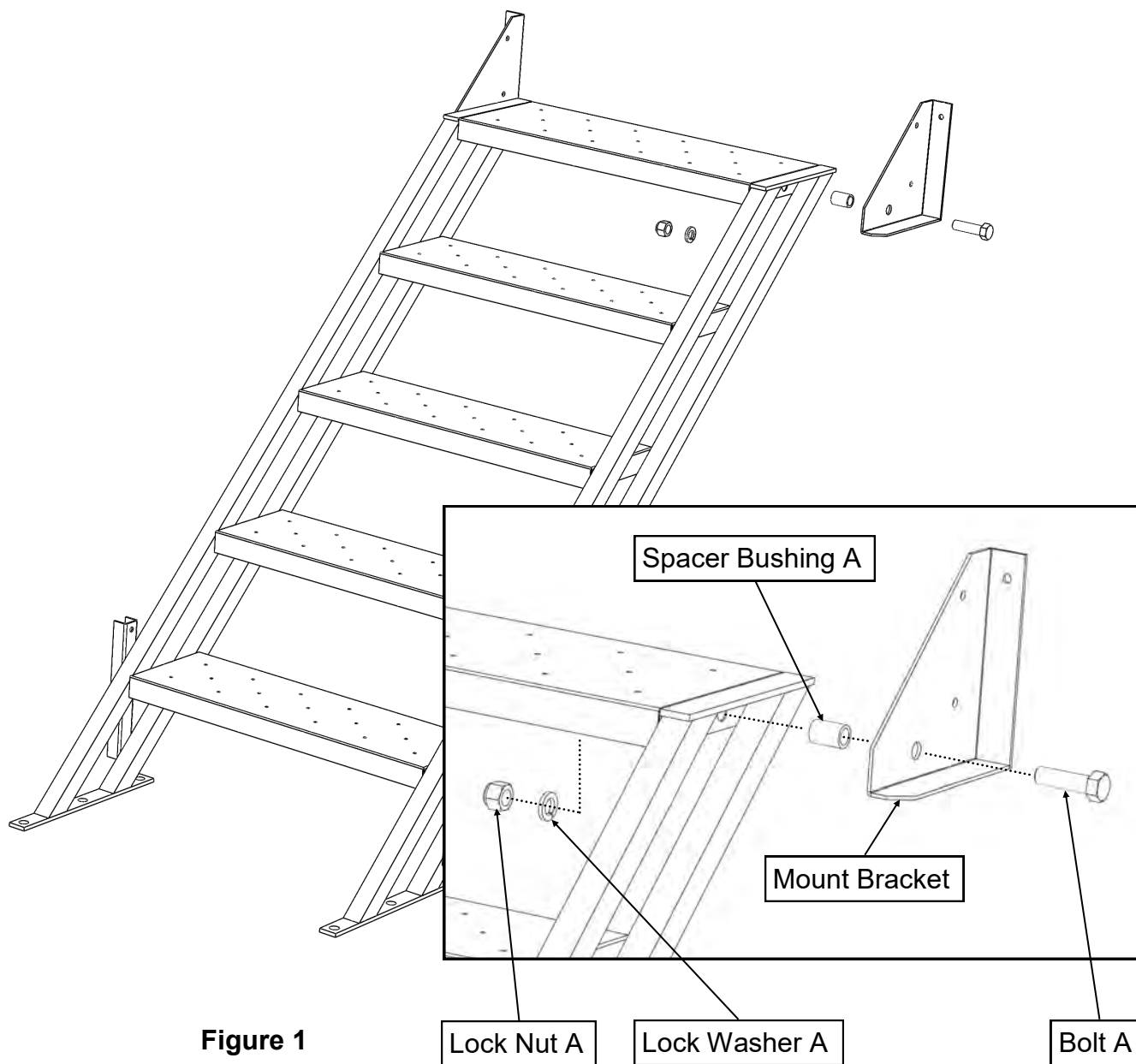

**Figure 1**



**Step 2:** Attach the **Top & Bottom Stair Assemblies** together using Bolt D, Lock Washer C & Lock Nut C. Install (3) bolts per side. Note: the upper section of the **Lower Handrail** gets installed at the same time. **Tighten all hardware securely.** (Figure 2 )

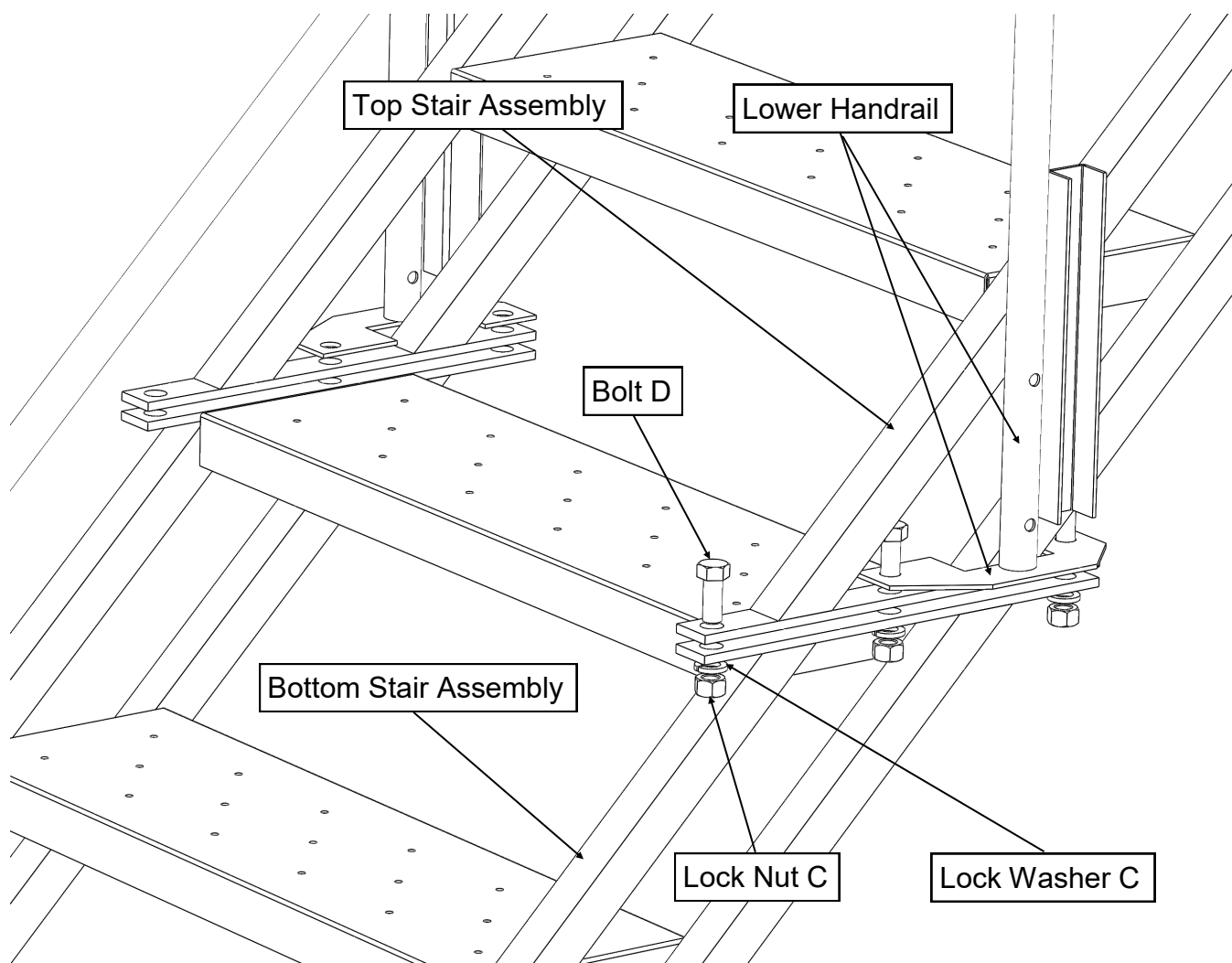

**Figure 2**



**Step 3:** Attach the bottom of the **Lower Handrails** to the bottom of the **Lower Stair Assembly** using Bolt C & Lock Nut B. Install (2) bolts per side. Note that the lowest bolt on each side is installed from the outside in. **Tighten all hardware securely.** (Figure 3 )

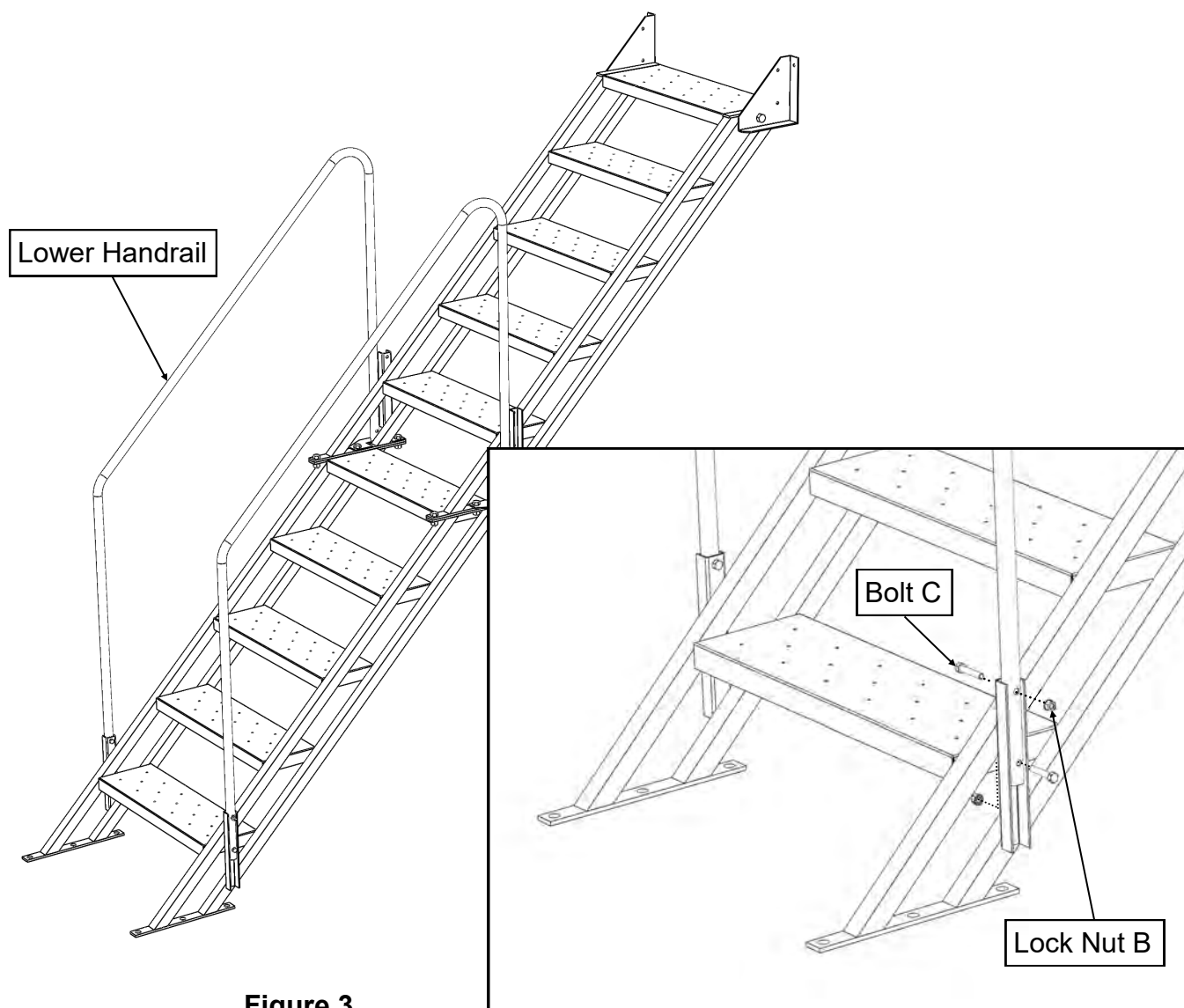

**Figure 3**

**Step 4:** Attach the **Upper & Lower Stair Assembly** to the **Base of the Blind** using Bolt B & Lock Nut B. Install (1) bolt per side. **Tighten all hardware securely.** (Figure 4 )

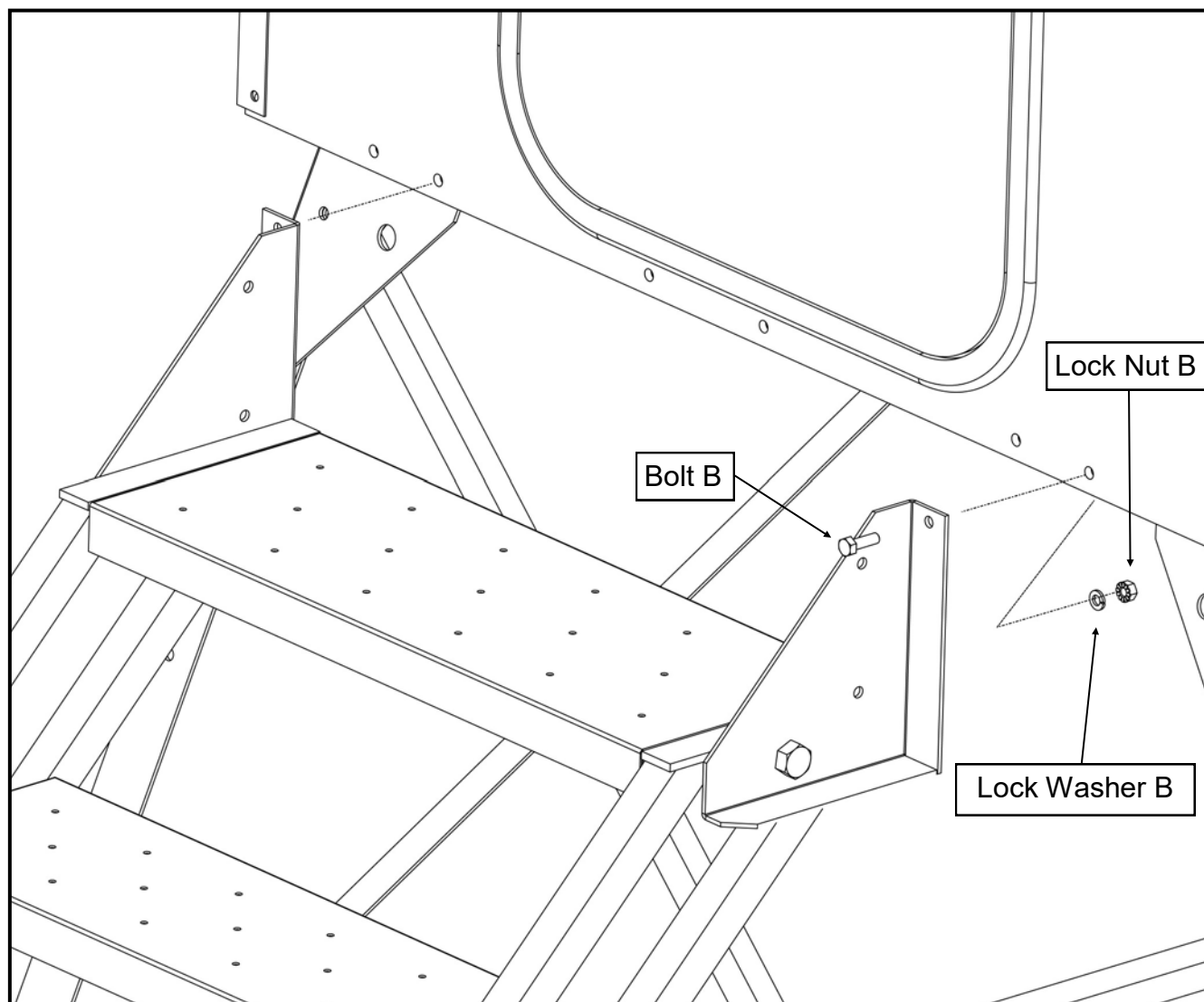

**Figure 4**

**Step 5:** Attach the **Upper Handrails** to the **Top Stair Assembly** using Bolt C & Lock Nut B. Install (4) bolts per side. Attach **Handrail Brackets** over gaps between **Upper & Lower Handrails** using Bolt C & Lock Nut B. Install (2) bolts per side. **Tighten all hardware securely. IMPORTANT: Go back & tighten Bolt A, Lock Washer A & Lock Nut A from Step 1. (Figure 5)**

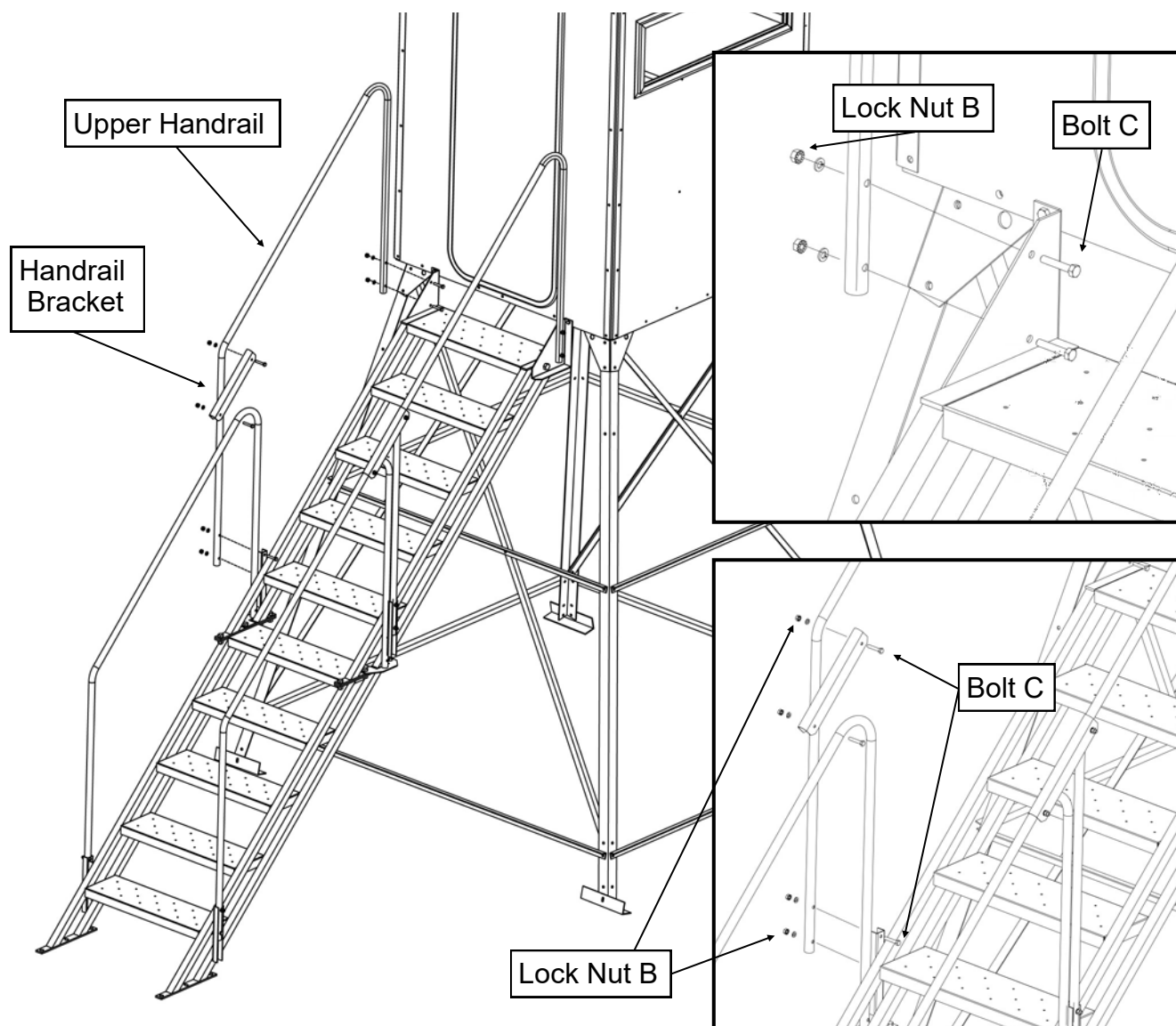

**Figure 5**